

The Perfect Fit for Wherever You Work

The compact and versatile ECOSYS PA2100cwx is the ultimate blend of productivity, high-quality and reliability, making it the ideal A4 printer for smaller workgroups or remote workspaces.

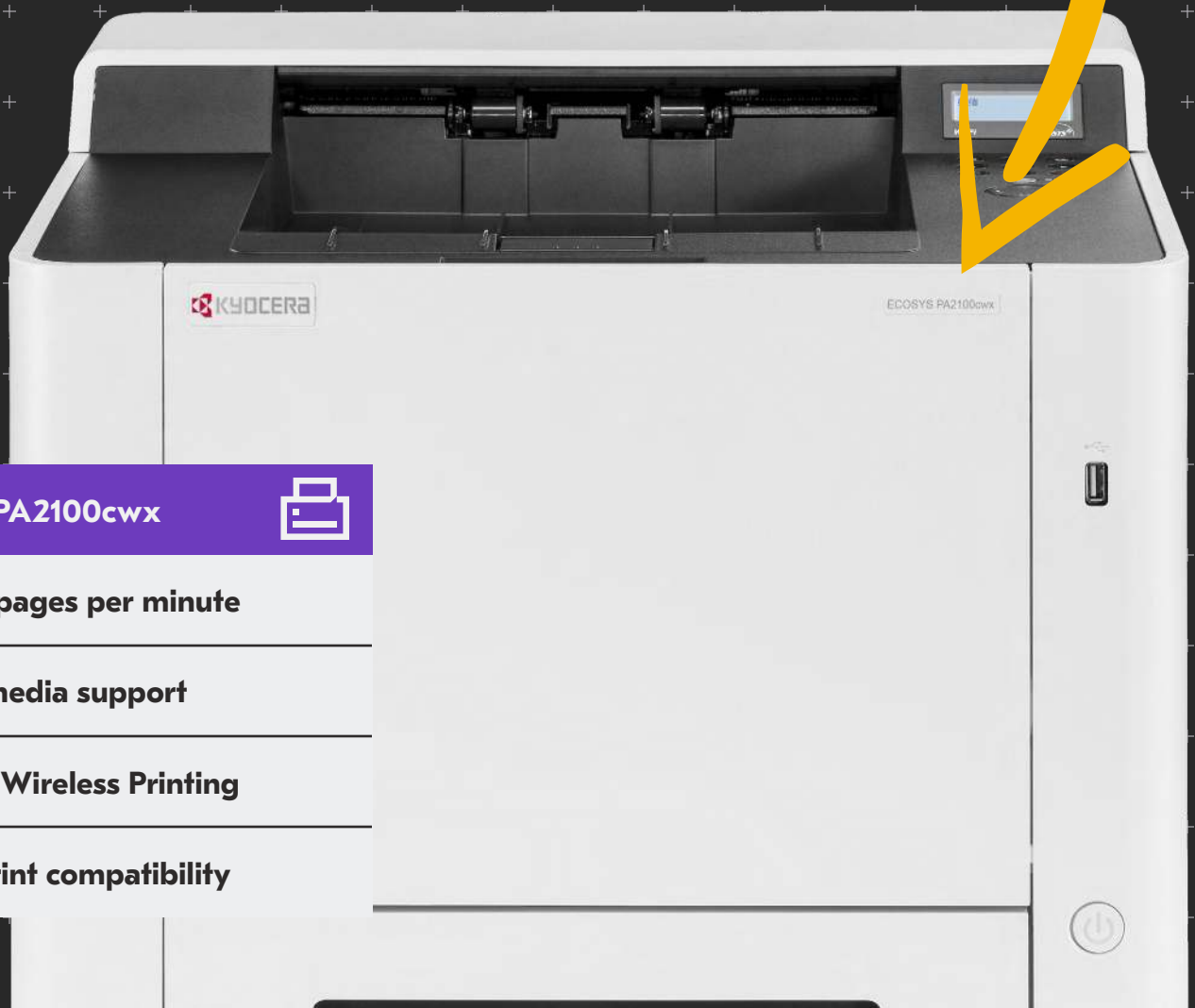

ECOSYS PA2100cwx



Up to 22 pages per minute

Flexible media support

Standard Wireless Printing

Mobile Print compatibility

BASIC SPECIFICATIONS

Configuration: KYOCERA ECOSYS® Color Network Printer
Pages Per Minute:
Black – Letter: 22 ppm, Legal: 18 ppm, A4: 21 ppm
Color – Letter: 22 ppm, Legal: 18 ppm, A4: 21 ppm
Warm Up Time: 32 Seconds or Less (Power On), 12 Seconds or Less from Sleep
First Page Out:
Print: 11 Seconds or Less Black, 12.5 Seconds or Less Color¹
Display: 2 Line LCD
Resolution: 600 x 600 dpi, 9600 dpi equivalent x 600 dpi, 1200 x 1200 dpi²
Memory: Standard 512MB
Duplex: Standard Stackless Duplex Supports Statement to Legal (5.5" x 8.5" – 8.5" x 14"), 16 – 32 lb Bond (60 – 120gsm)
Dimensions / Weight: 16.2" W x 16.2" D x 12.9" H / 46.3 lbs
Maximum Monthly Duty Cycle: 65,000 Pages per Month

POWER CONSUMPTION

Electrical Requirements: 120V, 60Hz, 8.6A; 220 – 240V, 50/60Hz, 4.5A
Typical Electricity Consumption (TEC): 120V: 763 Wh/week; 220 – 240V: 691 Wh/week
Maximum (including options): 120V: 985 W; 220 – 240V: 1,052 W
Printing: 120V: 345 W; 220 – 240V: 345 W
Ready Mode: 120V: 33 W; 220 – 240V: 33 W
Sleep Mode: 120V: 0.9 W; 220 – 240V: 0.9 W
Power Off: 120V: 0.2 W; 220 – 240V: 0.2 W

PRINT SPECIFICATIONS

Standard Controller: Cortex-A9 / 800MHz
PDLs / Emulations: PRESCRIBE, PCL6 (PCL5c/PCL-XL), KPDL3 Supporting AES, PDF Direct Print, XPS/OpenXPS Direct Print
Fonts: 93 Scalable Fonts for PCL6, 93 Fonts for KPDL3, 8 Fonts for Windows Vista, 1 Bitmap Font
Windows OS Compatibility: Windows 8.1/10/11 / Server 2012 /Server 2012 R2 / Server 2016 / Server 2019
Mac OS Compatibility: Apple Macintosh OS X 10.9 or higher
Interfaces: Standard: 10 BASE-T/100 BASE-TX / 1000 BASE-T, High-speed USB 2.0, 1 USB Host, Wireless LAN IEEE 802.11b/g/n, Wi-Fi Direct

Linux OS

Mobile Printing: Apple AirPrint®, KYOCERA Mobile Print, Mopria®
Network Protocols: TCP/IP, IPv4, IPv6, NetBEUI, FTP, LPR, IPP, WSD Print, DHCP, DNS, Apple Bonjour, SNMP v2/3, HTTP, SMTP, POP3, PDF Direct Print (using KYOCERA NET Direct Print utilities)
Drivers: KX Driver, KX (XPS) Driver, PCL Mini Driver, KPDL Mini Driver, MAC Driver, Linux Driver
Utilities: KYOCERA Net Direct Print, File Management Utility, KYOCERA Mobile Print, KYOCERA Print Center, KYOCERA Net Viewer, ID Register, Wi-Fi Setup Tool, Remote Work Assistant, Status Monitor
Job Management: 20 Department Codes
Additional Print Features: EcoPrint, Private Print, Proof and Hold; Quick Copy2 and Job Storage²

SECURITY SPECIFICATIONS

Standard: Network Authentication, IPsec, SNMPv3, LDAP over SSL, IEEE 802.1x, IPP over SSL/TLS, HTTPS, SMTP, POP3 over SSL/TLS, Enhanced WSD over SSL/TLS, TLS 1.2, SMBv3, SHA-2 384
Optional: Card Authentication Kit (B)

PAPER SUPPLY

Standard Paper Sources: Single 250 Sheet Drawer, 50 Sheet Multi-purpose Tray
Standard / Maximum Paper Sources: 2/3 including Multi-purpose Tray
Standard / Maximum Paper Capacity: 300 Sheets/550 Sheets
Paper Size: Standard / Optional / MPT Drawers: 5.5" x 8.5" – 8.5" x 14" (Statement to Legal)
Paper Weight: Standard / Optional Drawers: 16 lb Bond – 90 lb Index (60 – 163gsm); MPT: 16 lb Bond – 120 lb Index (60 – 220gsm)
Input Materials: Standard / Optional Drawer: Plain Paper, Bond Paper, Recycled Paper; MPT: Labels, OHP, Envelopes, Coated Paper

PAPER HANDLING OPTION

PF-5110: 250 Sheet Paper Feed Drawer
Paper Size / Weight: 5.5" x 8.5" – 8.5" x 14" (Statement to Legal) / 16 lb Bond – 90 lb Index (60 – 163gsm)
Dimensions / Weight: 16.1" W x 17.6" D x 5.5" H / 8 lbs.

ADDITIONAL OPTIONS

SD Card: 16 / 32GB
Security: Card Authentication Kit (B)
Print Management: ThinPrint (UG-33)

Note:
¹ At reduced speed
² Requires optional SD Card

Specifications and design are subject to change without notice. For the latest on connectivity visit kyoceradocumentsolutions.us. ECOSYS, PRESCRIBE, Kyocera Net Manager, Kyocera Net Viewer, Kyocera Device Manager, PDF Direct Print, Command Center RX, and KX Driver are trademarks of The Kyocera Companies. Mac OS and AirPrint are trademarks of Apple, Inc. Mopria is a trademark of Mopria Alliance, Inc. Windows is a trademark of Microsoft, Inc. All other trademarks are the property of their respective owners.

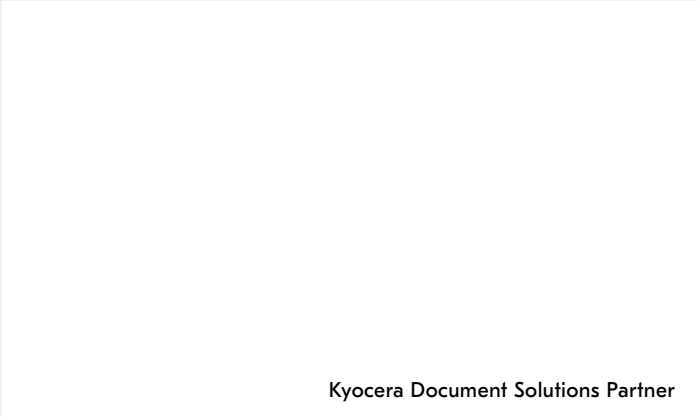

KYOCERA Document Solutions America
 225 Sand Road, PO Box 40008
 Fairfield, New Jersey 07004-0008, USA
 Tel: 973-808-8444



kyoceradocumentsolutions.us