

# Your digital tool for the modern workplace

Boost your business growth and take your productivity to the next level with the ECOSYS PA3500cx printer. Made for medium to large-size work groups, this A4 color device is designed to stand the test of time with long-life components that help to reduce waste and ensure exceptional levels of reliability and data security.

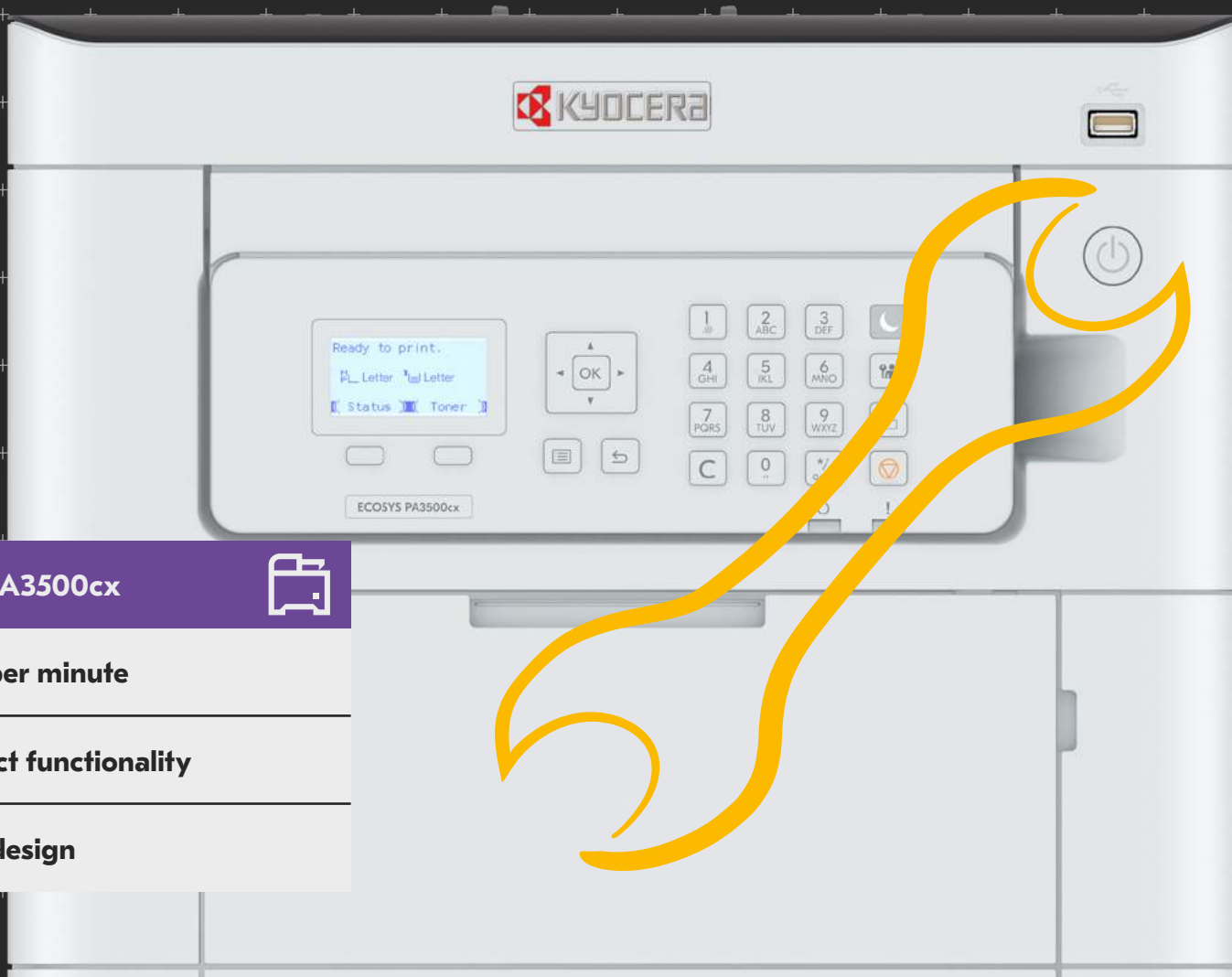

**ECOSYS PA3500cx**



**37 pages per minute**

**Wi-Fi Direct functionality**

**Compact design**

## Specifications

### GENERAL

**Configuration:** Color Printer

**Black/Color - Letter:** 37 ppm; Legal: 30 ppm; A4: 35 ppm

**Duplex Print Speed:** Letter 18.5 ppm; Legal 15 ppm; A4 17.5 ppm

**Display:** 5 Line LCD with 10 Key Control Panel

**Warm Up Time:** 23 Seconds or Less (Power On)

**First Page Out Time:**

**Print:** 5.7 Seconds or Less Black, 7.0 Seconds or Less Color

Resolution: 1200 x 1200 dpi<sup>1</sup>, 9600 dpi x 600 dpi, 600 x 600 dpi

**Memory:** Std/Max: 1 GB / 1 GB

**Duplex:** Standard Stackless, Supports Statement to Legal (5.5" x 8.5" - 8.5" x 14"), 16 lb Bond - 90 lb Index (60 - 163gsm)

**Dimensions / Weight:** 15.5" W x 20.9" D x 15.5" H 78.2 lb  
Maximum Monthly Duty Cycle: 100,000 Pages per Month

### POWER CONSUMPTION

**Electrical Requirements:** 120V, 60Hz, 11.8A; 220-240V, 50/60Hz, 5.4A

**Typical Electricity Consumption (TEC):** 120V: 0.32 kWh/week; 220-240V 0.32 kWh/week

**Maximum (Including options):**

120V: 1,288W; 220-240V: 1,278W

**Printing:** 120V: 541.6W; 220-240V: 496.4W

**Ready Mode:** 120V: 11.1W; 220-240V: 11.8W

**Sleep Mode:** 120V: 0.4W; 220-240V: 0.5W

**Power Off:** 120V: 0.1 W; 220-240V: 0.1 W

### PRINTER SPECIFICATIONS

**Standard Controller:** ARM Cortex-A9 Dual core 1.2GHz + ARM Cortex-M3 100MHz

**PDLs / Emulations:** PRESCRIBE, PCL6 (PCL-XL/PCL-5c),

KPDL3, XPS, OpenXPS, PDF

**Fonts:** PCL6, KPDL, Calibri, Cambria and Bitmap

**Barcodes:** 1 Dimensional: 45 Type; 2

**Dimensional:** PDF417 1 Type

**Windows OS Compatibility:** Windows 8.1, Windows 10,

Windows 11, Windows Server 2012/R2, 2016, 2019

**MAC OS Compatibility:** MAC OS X 10.9 or greater

**Google Chrome OS:** version 118 or higher

**Linux OS Compatibility:** Linux PPD

**Interfaces:** 10 BASE-T/100 BASE-TX/1000 BASE-TX,

2 High-Speed USB 2.0 Ports, 1 Expansion Slot; Optional:

Wireless IB-37, IB-38, IB-51

**Mobile Printing:** KYOCERA Mobile Print, KYOCERA MyPanel,

KYOCERA Print Service Plugin, Apple AirPrint®, Mopria®

**Network Print and Supported Protocols:** TCP/IP, IPv4, IPv6,

NetBEUI, LPR, Port9100, IPP, WSD Print, DHCP, DNS, PnP-X,

USB, LDAP/LDAPS, PDF Direct Print, PnP-X (WS-Discovery

for WSD Print Service)

**Drivers:** KX Driver, PCL Uni Driver, KPDL Uni Driver,

MAC Driver, Linux Driver, Chrome Driver

**Utilities:** KYOCERA Net Direct Print, File Management

Utility, KYOCERA Print Center, KYOCERA Net Viewer,

KYOCERA Device Manager, ID Register, Web Installer,

Quick Network Setup, Maintenance Menu, Kyocera Net

Manager (Pro & Basic), ID Register, Wi-Fi Setup Tool,

Command Center RX; KYOCERA Fleet Services (KFS)

**Additional Print Features:** EcoPrint, Private Print, Proof and

Hold, Quick Copy and Job Storage<sup>2</sup>, Gloss Mode, Border

Erase, Prevent Color Bleed-thru, Background Density

Adjustment; MPT: Banner Printing

### SECURITY SPECIFICATIONS

**Standard:** Local & Network Authentication, IPsec,

HTTPS, SNMPv3, IPPS, POP over SSL; LDAPS, Overwrite

& Data Encryption with optional SSD, SHA-2, TLS 1.3

### PAPER SUPPLY

**Standard Paper Sources:** Single 550 Sheet Drawer,

100 Sheet Multipurpose Tray (20 lb. Bond)

**Standard / Maximum Paper Capacity:**

650 Sheets / 2,300 Sheets

**Paper Size:** Statement to Legal (5.5" x 8.5" - 8.5" x 14"),

Custom; MPF: Envelope, Banner

**Paper Weight:** Standard / Optional Drawers:

16 lb. Bond - 32 lb. Bond. (60 - 120gsm);

MPT: 16 lb. Bond - 110 lb. Index (60 - 220gsm)

**Standard Output Tray Capacity:** 250 Sheets

**Input Materials:** Plain, Preprint, Bond, Recycled, Thin,

Letterhead, Color, Pre-punched, Thick, High Quality, Custom;

MPT; Envelope, Coated, Cardstock, Transparency, Labels

### PAPER HANDLING OPTIONS

**PF-5150:** Paper Feed Cassette (550 Sheet x 3)

**Paper Size:** Statement to Legal (5.5" x 8.5" - 8.5" x 14"),  
Envelope, Custom Paper Weight: 16 lb Bond - 120 lb Index  
(60 - 220gsm)

**Input Materials:** Plain, Preprint, Bond, Recycled, Thin,  
Letterhead, Color, Pre-punched, Thick, High Quality, Custom;

MPT; Envelope, Coated, Cardstock, Transparency, Labels

**Dimensions / Weight:** 15.5" W x 21" D x 4.6" H / 9.7 lbs

### ADDITIONAL OPTIONS

**Print Management:** ThinPrint (UG-33)

**Security:** Optional: Card Authentication Kit (B)

**SD Card:** 16 / 32 GB

**SSD:** HD-17: 64 GB SSD / HD-18: 256 GB SSD / HD-19: 512 GB SSD

**Wireless LAN:** IB-37, IB-38, IB-51

**Additional NIC:** IB-50 Dual Gigabit NIC

Barcode Flash Option for advanced barcode printing

**Note:**

<sup>1</sup>At Reduced Speed

<sup>2</sup>Requires Optional SD Card or SSD

ECOSYS stands for ECOlogy, ECONomy and SYStem printing. With their long-life components, ECOSYS devices are designed to maximise durability and minimise the total cost of ownership with regard to maintenance, administration and consumables. The cartridge-free system means that only the toner has to be replaced regularly. The modular design concept allows you to add workflowenhancing functions as required. Integrated system software provides long-term crossnetwork compatibility. KYOCERA's long-life components cost you and the environment less.



**KYOCERA Document Solutions Partner**

SEP2023ECOSYSPA3500cx/VER1.0

KYOCERA Document Solutions America  
225 Sand Road, PO Box 40008  
Fairfield, New Jersey 07004-0008, USA  
Tel: 973-808-8444



[kyoceradocumentsolutions.us](http://kyoceradocumentsolutions.us)

\* KYOCERA Document Solutions does not warrant that any specifications mentioned will be error-free. Specifications are subject to change without notice. Information is correct at time of going to press. All other brand and product names may be registered trademarks or trademarks of their respective holders and are hereby acknowledged.

\*\* Depending on the country